

.079"(2.00mm) pitch Wire to Wire Connectors Housing

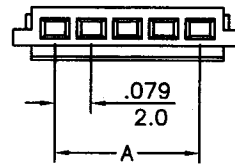

H5105 Series

- * Poles:2-10
 - * Material:NYLON 66 UL 94V-0
 - * Suitable T5105T series terminal
 - * Mates with H5106-XX series
- Specifications
- * Voltage rating: 125V AC, DC
 - * Temperature range: -25°C~+85°C
 - * Insulation resistance: 1,000MΩ min.
 - * Withstand voltage: 500V AC/minute



inches
mm

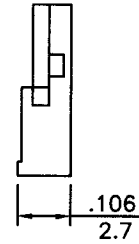
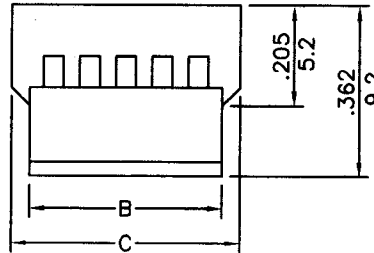

CKTS	PART NO.	DIMENSION in.(mm)		
		A	B	C
2	H5105-02	0.079(2.0)	0.177(4.5)	0.256(6.5)
3	H5105-03	0.157(4.0)	0.256(6.5)	0.335(8.5)
4	H5105-04	0.236(6.0)	0.335(8.5)	0.413(10.5)
5	H5105-05	0.315(8.0)	0.413(10.5)	0.492(12.5)
6	H5105-06	0.394(10.0)	0.492(12.5)	0.571(14.5)
7	H5105-07	0.472(12.0)	0.571(14.5)	0.650(16.5)
8	H5105-08	0.551(14.0)	0.650(16.5)	0.728(18.5)
9	H5105-09	0.630(16.0)	0.728(18.5)	0.807(20.5)
10	H5105-10	0.709(18.0)	0.807(20.5)	0.886(22.5)

.079"(2.00mm) pitch female crimp terminal

T5105T Series

- * Material:Brass
- * Finished:Tin-plated
- * Used in H5105-XX series housings
- * Wire range:AWG#24~#28
- * Insulation O.D:1.1-1.5mm
- * Thickness:0.2mm
- * Q'TY:10,000pcs/reel

inches
mm

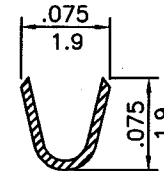
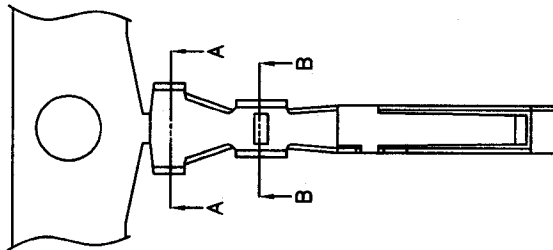

A-A SECTION

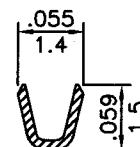
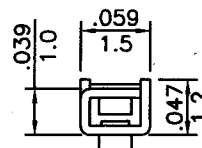
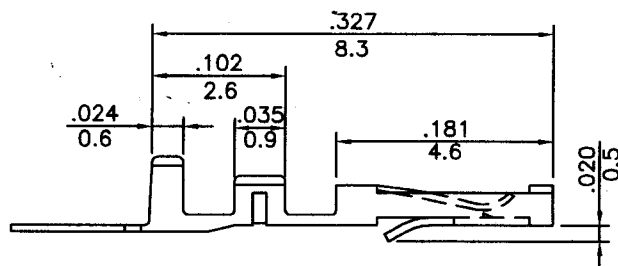

B-B SECTION