

# .163"(4.14mm) pitch crimp terminal



## T66A5/T66A6 Series

- \* Material: Brass.
- \* Finished: Tin-plated
- \* Used in H66A5/H66A6 series housings
- \* Wire range: AWG#18~#24
- \* Insulation O.D.: 3.0mm(max)
- \* Thickness: 0.20mm
- \* Q'TY: 4,000pcs/reel

Pc Board Socket

P/N: T66A5P Used in H66A6/H66A6E

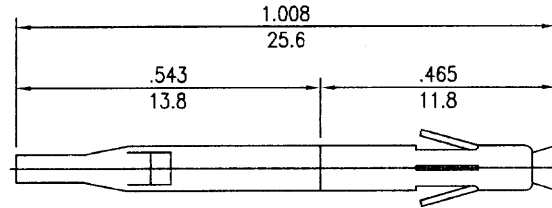

inches  
mm

P/N: T66A5 Used in H66A5

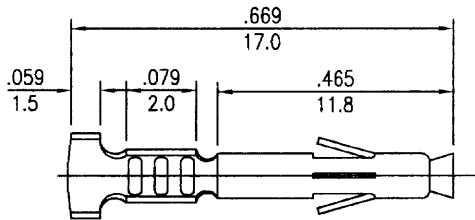

P/N: T66A6 Used in H66A6/H66A6E

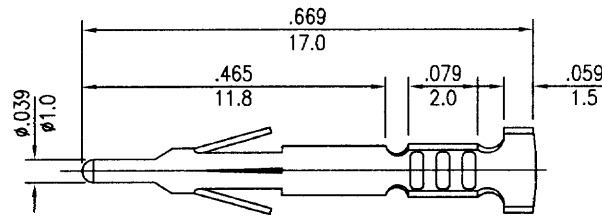

# .163"(4.14mm) pitch connectors

## H66A5/H66A6 Series

- \* Poles: 1,2,3,4,6,9,12,15
  - \* Material: NYLON 66 UL94V-2
  - \* Suitable T66A5/T66A6 series terminal
- Specifications
- \* Current rating: 5A AC, DC
  - \* Voltage rating: 300V AC, DC
  - \* Temperature range: -25°C~+90°C
  - \* Insulation resistance: 1,000M $\Omega$  min.
  - \* Withstand voltage: 1,500V AC/minute
  - \* Tolerance:  $\pm 0.3$ mm

inches  
mm

P/N: H66A5-01

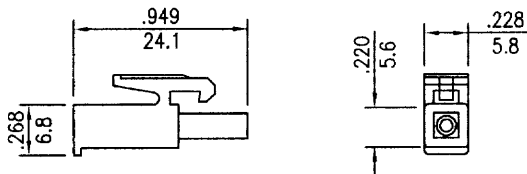

P/N: H66A6-01

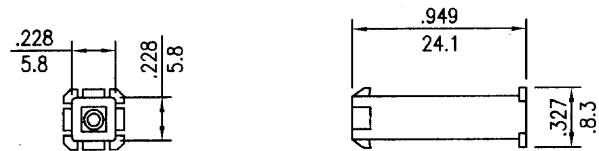

P/N: H66A5-02

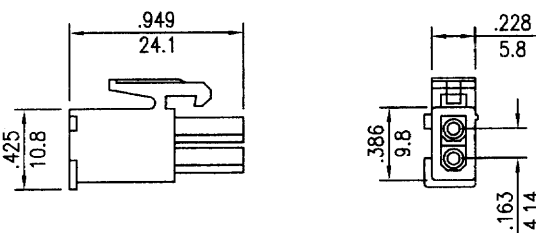

P/N: H66A6E-02

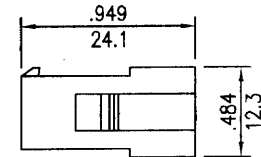
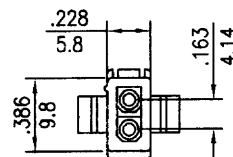

P/N: H66A6-02

