

■ TERMINAL

- Part No: CT251T
- Material: Brass
- Thickness: 0.2mm
- Plating: Tin plated
- Wire Range: Suitable for AWG#22~28
- Insulation O.D: 1.5mm (max)
- Q'TY: 10,000 pcs/roll
- Accepts housing :CH251, CH251Z Series

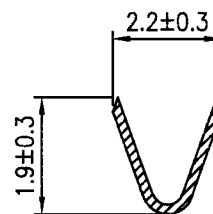

A-A SECTION

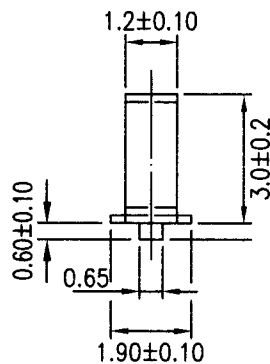
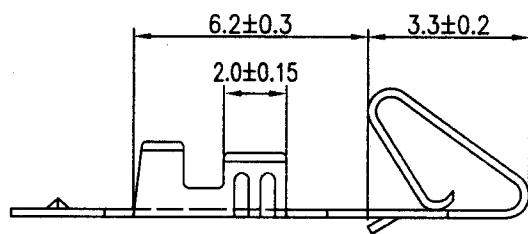
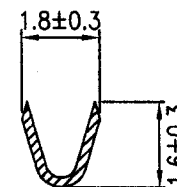

B-B SECTION

詮盛企業股份有限公司 CHIEN SHERN ENTERPRISE CO.,LTD.	TITLE	2.54mm Pitch Crimp Terminal	TOLERANCE	DRAWN	DATE	2005.11.02
	PART NO.	CT251T	DIM.	CHECK	DATE	
	DWG.NO.	CT251T	0.0 ±0.30	APPROVE	DATE	
			0.00 ±0.20	SCALE	UNIT	mm
			0.000 ±0.08			